



Pathways to Adventure Travel

International Diving Expeditions: IDE

Travel Concepts International

CST #2006081-40 ARC/IATAN

5253 Bucks Bar Road Placerville, CA 95667

Office: 530-622-9124 Mobile: 916-952-9124 FAX: 530-626-0677

Pathways2Adventure@gmail.com www.PathwaystoAdventure.com

Papua New Guinea Liveaboard : **MV FeBrina**

October 30 - November 8, 2012.....Trip will start earlier..? 10/20, 21 or 26, 2012**

(all subject to personal plans) for some to explore some of the cultural offerings of Papua New Guinea.



MV FeBrina-9 night, 7½ dive days *Itinerary:* Kimbe Bay & Fathers Reefs*

\$3795-\$4175 +\$\$ Savings... *always....call for our special prices....*

Deposit of \$1,000.00 to confirm your reservation

Inclusions:

All meals and snacks,
Complimentary wine with dinner.
7 1/2 days diving, 4 – 5 dives per day.
Airport transfers to New Britain /Walindi Resort
..and of course GREAT FUN !!

Exclusions:

International airfare: use mile awards or call for flight assistance.. avoid flights which require an overnight in Port Moresby
Pre-trip arrangements; lodging/ Walindi Resort prior to boarding/Excursions
Nitrox and any rental gear you may require.
Personal items, crew/service tips , VISA fee, taxes not previously included

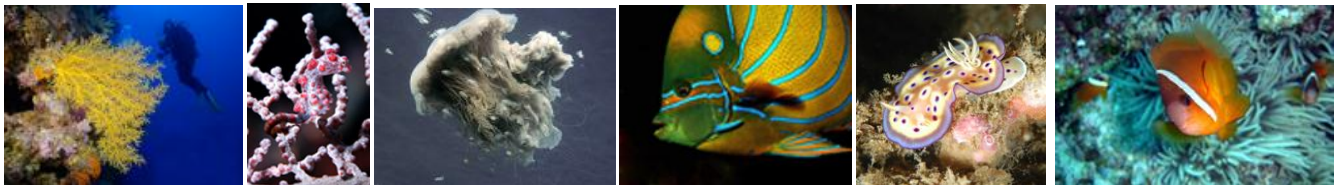

Above image: by Joe Herrlie

***Itinerary:** Kimbe Bay & Fathers Reefs The waters of New Britain are home to pristine and colorful corals and a variety of fish, crustacean, invertebrate life, and many pelagic species including sharks, tuna, jacks, barracuda, turtles and rays. Fathers Reef are a series of off shore reefs, which are sunken remains of a huge extinct *volcano*, with interesting topography, swim-throughs and arches.

**** Pretrip:** Arrive early for time to explore mainland PNG: Mt Hagan and highland areas. A 2N min at Walindi Resort advised to adjust and explore **New Britain Island** before boarding MV Febrina.
Attractions: Volcanoes, Bush Walking, Waterfalls, Guru Hot River, Open air Market & Cultural Center.

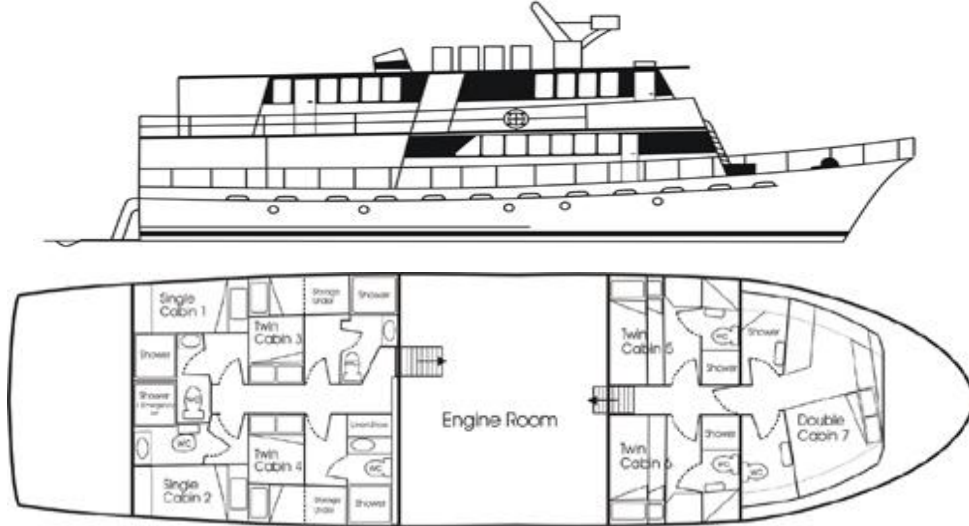

The MV FeBrina has been rebuilt in 2010 with the addition of an upper deck, relocation of the wheelhouse from main deck to upper deck, totally rebuilt forward cabins to 3 ensuite cabins and a total re-power of the boat with replacement of main engines and generators.

Today, MV FeBrina is 73 feet of liveaboard comfort and convenience. She is a stable and extremely seaworthy motor vessel, well set up and catering for serious divers and photographers who want a total PNG dive experience.

MV FeBrina's crew is locally trained as divers, and they specialize in combining excellent service and meals in combination with the ultimate diving experience. They are extraordinarily good "spotters" often pointing out elusive and rarely seen critters, much to everyone's delight.

The boat has 7 comfortable, individually air conditioned cabins for a maximum of 12 guests. 2 cabins are for single occupancy, 1 cabin appointed with a double bed, and 4 cabins with bunk beds are for double occupancy. Each cabin has a plentiful supply of towels with daily laundering. The cabins have been custom built to include plenty of storage area and make maximum use of space available. Bathroom facilities all have regular flush toilets. There is ample room in the salon for dining, socializing, and reviewing images from the day's dives or watching movies. The dive deck is well designed for ease of donning your gear and entering the water via the water level duckboard. (For more details visit www.febrina.com)



All images taken by Carol Herrlie (except one noted on front and those of the Febrina were used with permission).